



Toe Jack V5

Features:

- Forged, steel safety toe, which is stronger than the industry standard of cast steel
- A peg on the back of the toe that secures correct insertion
- Same loading capacity on the toe and the head
- 3 starting positions



Technical data	V5
Item number	1-10181
Full load capacity	11,000 lbs. / 50kN (5 t)
Working pressure	7,542 psi / 520bar
Minimum loading height using safety toe	0.6" / 15 mm
Lifting height	5.5" / 140 mm
Number of toe positions	3 x
Loading height using top plate	10" / 252 mm
Overall dimensions (L x W x H)	11.2 x 9.3 x 10" / 285 x 235 x 252 mm
Weight with oil	46 lbs./ 21 kg

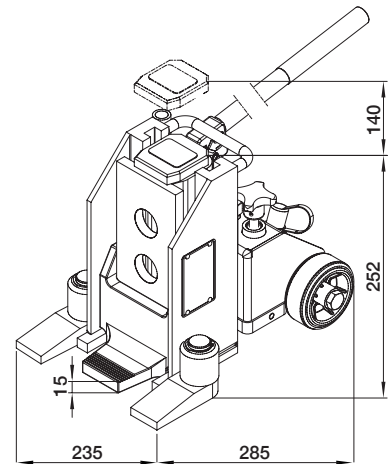



Toe Jack V10

Features:

- Forged, steel safety toe, which is stronger than the industry standard of cast steel
- Swivel feet to increase stability
- Same loading capacity on the toe and the head
- 4 starting positions



Technical data

V10

Item number	1-10182
Full load capacity	22,000 lbs. / 100kN (10 t)
Working pressure	7,542 psi / 520 bar
Minimum loading height using safety toe	0.8" / 20 mm
Lifting height	6.3" / 160 mm
Number of toe positions	4 x
Loading height using top plate	12.2" / 310 mm
Overall dimensions (L x W x H)	14 x 10.2 x 12.2" / 357 x 260 x 310 mm
Weight with oil	71 lbs. / 32 kg

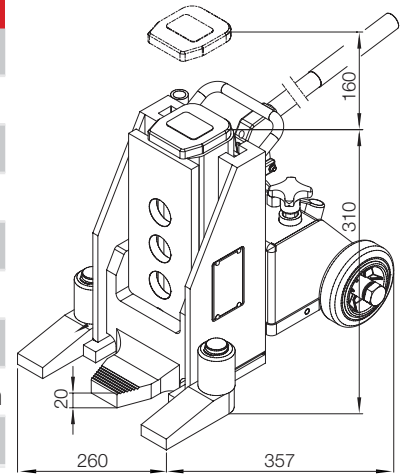



Toe Jack V15

Features:

- Forged, steel safety toe, which is stronger than the industry standard of cast steel
- Ability to operate manually or with a hydraulic pump
- Same loading capacity on the toe and the head
- 4 starting positions



Technical data

V15

Item number	1-10183
Full load capacity	33,000 lbs. / 150kN (15 t)
Working pressure	7,542 psi / 520 bar
Minimum loading height using safety toe	1" / 25 mm
Lifting height	6.3" / 160 mm
Number of toe positions	4 x
Loading height using top plate	12.5" / 318 mm
Overall dimensions (L x W x H)	15.9 x 12.6 x 12.5" / 403 x 320 x 318 mm
Weight with oil	117 lbs. / 53 kg

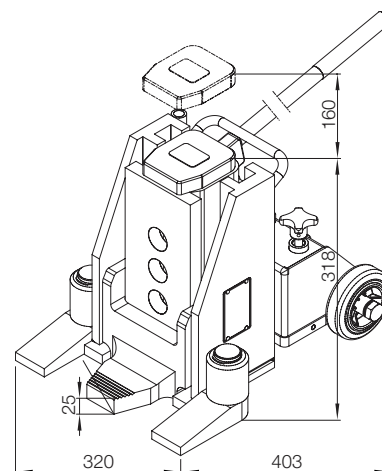



Toe Jack V20

Features:

- Forged, steel safety toe, which is stronger than the industry standard of cast steel
- Fast stroke and slow stroke cylinders to facilitate manual lifting operation
- Ability to operate manually or with a hydraulic pump
- 3 starting positions



Technical data

V20

Item number	1-10184
Full load capacity	44,000 lbs. / 200kN (20 t)
Working pressure	7,542 psi / 520 bar
Minimum loading height using safety toe	1.2" / 30 mm
Lifting height	6.3" / 160 mm
Number of toe positions	3 x
Loading height using top plate	12.8" / 325 mm
Overall dimensions (L x W x H)	16.7 x 12.8 x 12.8" / 425 x 326 x 325 mm
Weight with oil	159 lbs. / 72 kg

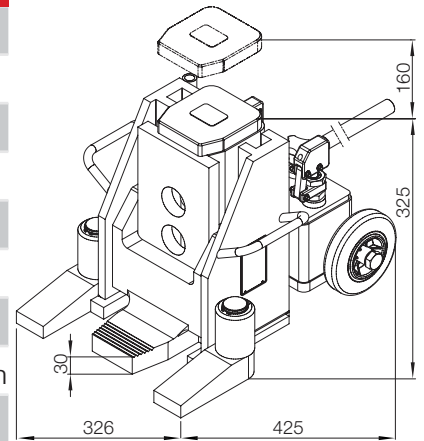



Toe Jack V5-EX

Features:

- Must be used with an external pump
- Designed for applications with difficult to access spaces or where a safety distance from the load is required
- Same loading capacity on the toe and the head
- 3 starting positions



Technical data

V5-EX

Item number	1-10185
Full load capacity	11,000 lbs. / 50kN (5 t)
Working pressure	7,542 psi / 520 bar
Minimum loading height using safety toe	0.6" / 15 mm
Lifting height	5.5" / 140 mm
Number of toe positions	3 x
Loading height using top plate	10" / 252 mm
Overall dimensions (L x W x H)	8.9 x 8.3 x 10" / 227 x 212 x 252 mm
Weight	38 lbs. / 17 kg

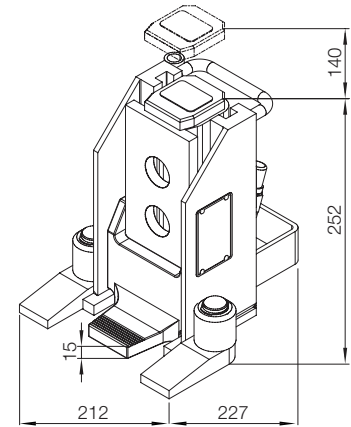



Toe Jack V10-EX

Features:

- Must be used with an external pump
- Meant for applications with difficult to access spaces or where a safety distance from the load is required
- Swivel feet to increase stability
- 4 starting positions



Technical data

V10-EX

Item number	1-10186
Full load capacity	22,000 lbs. / 100kN (5 t)
Working pressure	7,542 psi / 520 bar
Minimum loading height using safety toe	0.8" / 20 mm
Lifting height	6.3" / 160 mm
Number of toe positions	4 x
Loading height using top plate	12.2" / 310 mm
Overall dimensions (L x W x H)	11 x 9.3 x 12.2" / 280 x 237 x 310 mm
Weight	60 lbs. / 27 kg

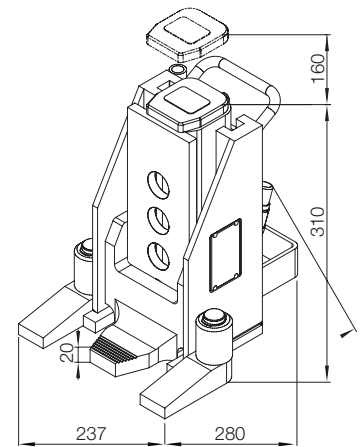



Toe Jack V15-EX

Features:

- Must be used with an external pump
- Designed for applications with difficult to access spaces or where a safety distance from the load is required
- Forged, steel safety toe, which is stronger than the industry standard of cast steel
- 4 starting positions



Technical data

	V15-EX
Item number	1-10527
Full load capacity	33,000 lbs. / 150kN (15 t)
Working pressure	7,542 psi / 520 bar
Minimum loading height using safety toe	1" / 25 mm
Lifting height	6.3" / 160 mm
Number of toe positions	4 x
Loading height using top plate	12.2" / 310 mm
Overall dimensions (L x W x H)	13.9 x 12 x 12.5" / 353 x 304 x 318 mm
Weight	94 lbs. / 43 kg

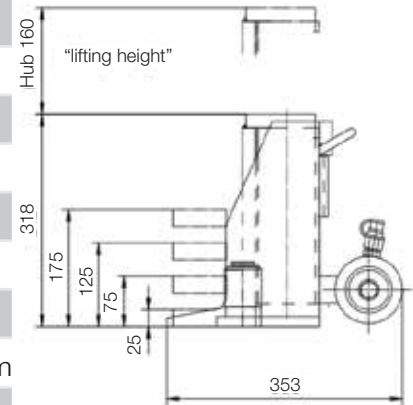



Toe Jack V15-EX 270

Features:

- A higher stroke jack designed for higher lifting applications, like the ROBOT 40
- Electric pump must be used for operation
- Forged, steel safety toe, which is stronger than the industry standard of cast steel
- 2 starting positions



Technical data

V15-EX 270

Item number	1-14022
Full load capacity	33,000 lbs. / 150 kN (15 t)
Working pressure	7,542 psi / 520 bar
Minimum loading height using safety toe	1" / 25 mm
Lifting height	10.6" / 270 mm
Number of toe positions	2 x
Loading height using top plate	20.4" / 518 mm
Overall dimensions (L x W x H)	14 x 12 x 20.2" / 354 x 304 x 514 mm
Weight	185.2 lbs. / 84 kg

